

DESCRIPTION

ThermalDrain™ is a user friendly synthetic protection board that is a great alternative to fiberglass. Thermal Drain is more durable than fiberglass and provides excellent drainage. ThermalDrain is also the only protection board providing R-Value that contains 70% post-consumer recycle content. Our environmentally friendly drainage board will not irritate your skin and is easy to work with. ThermalDrain is designed to be used with spray applied waterproofing and when used with BoneDry™ WPT from DryDog Barriers provides a great system of protection for many years to come. Contact GMX, Inc. today for more information on how to go GREEN with ThermalDrain.

PRODUCT ADVANTAGES

- No more itching
- More durable than fiberglass
- Flexible, bends easily
- Environmentally friendly, 70% post-consumer recyclable

TECHNICAL DATA

Properties	Thermal Drain		
Board Thickness	3/4"	1 3/16"	2 3/8"
Drainage Ability (Test Method ASTM D 4716*) Gallons/Hour/Lineal ft.	85	135	270
Resistance Thermal Resistance *Hydraulic gradient of 1.0	R-3	R-5	R-10

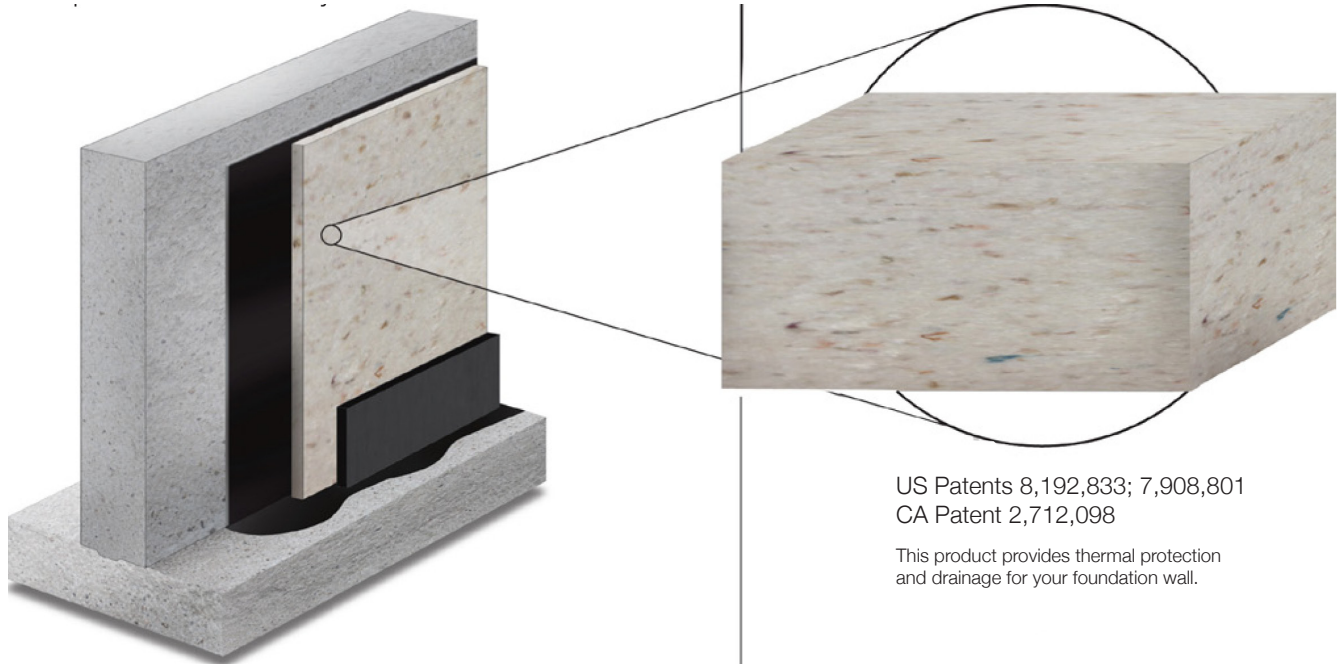

US Patents 8,192,833; 7,908,801
CA Patent 2,712,098

This product provides thermal protection and drainage for your foundation wall.

The information and recommendations discussed in this publication are believed to be correct. The ASTM testing is conducted by an independent accredited laboratory. No statement should be construed as a recommendation for any use, which would violate any patent rights. This document is not a guarantee of a warranty, if approved by GMX, Inc., a performance warranty may be granted.